

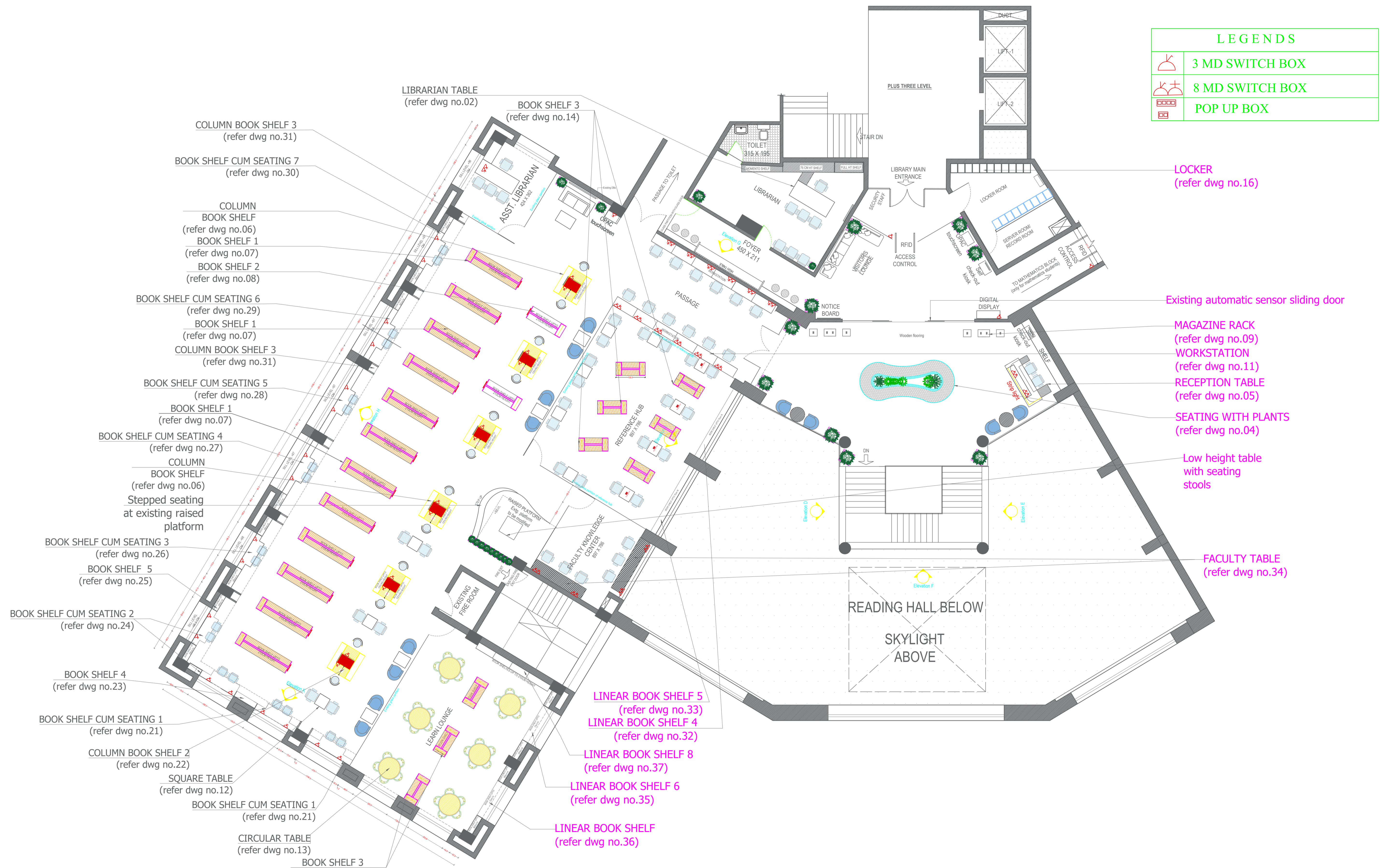

LEGENDS	
	3 MD SWITCH BOX
	8 MD SWITCH BOX
	POP UP BOX



PROPOSED INTERIOR DESIGN OF THE CENTRAL LIBRARY AT SECOND FLOOR & THIRD FLOOR OF ADMINISTRATIVE COMPLEX IN IISER THIRUVANANTHAPURAM

<p>Notes:</p> <ol style="list-style-type: none"> This drawing is the sole property of M/s P. Rasheed and Associates. The rights of reproduction, modification or alteration are reserved by the consultant. This drawing is not to be used for any other purpose or any other project. No dimensions are to be scaled out from the drawing. Figured dimensions should be followed. Check all measurements and levels before commencing the work. Intimate the consultant before starting the construction. 	<p>REMARKS:</p> <ol style="list-style-type: none"> Dimensions are in Meters Do not scale out the drawing Columns, Beams sizes as per structural details Latelite for masonry is 20cm thick, unfinished size (The size shown in the drawing) Plastering thickness 1.5cm (Unless specified) 	<p>Consultant:</p> <p>P.C. RASHEED AND ASSOCIATES.</p> <p style="font-size: small;">REGD OFFICE: 80/1, KALAMANGALAM, THIRUVANANTHAPURAM CONTACT: 9447080000, 9447080001 EMAIL: p.c.rasheedandassociates@gmail.com p.c.rasheed@pcrasheed.com MOBILE: 91 9895444461, 91 9427464441</p>	<p>CHIEF CONSULTANT:</p> <p>Er P.C.ABDUL RASHEED B-Tech, FIISLA, FIIV. REGISTERED ENGINEER-A REGN NO CI-3140/2000/69/EA</p>	<p>Drawn By: Ar. Naval Muhammed Ar. Ridha K Er. Theertha T Er. Noufan VP</p> <p>CLIENT: IISER Thiruvananthapuram</p>	<p>TITLE: PROPOSED THIRD FLOOR LAYOUT</p> <p>Scale: 1:100</p> <p>Date: 29/01/2026</p>	<p>DWG NO. EDR 02</p>
--	---	--	---	--	--	--